



Dillsboro, Indiana
(Dearborn County)

Small Town 5-Year Parks & Recreation
Master Plan
2023

13030 Executive Dr • Dillsboro, IN 47018 • Phone: (812) 432-3243 • Fax: 812.432.3085

Table of Contents

Plan Author	3
Park Board Statutory Compliance & Board Contact Information	3
List of Park Department Paid Staff	4
Definition of Planning Area	4
Natural Features & Landscape	4
Man-made, Historical, & Cultural	5
Social & Economic Factors	7
Largest Employers	8
Park Department Information & Facility Inventory	9
Accessibility & Universal Design	9
Public Participation	10
Survey Information	10
Public Meeting Information	11
Needs Analysis	11
Community Map & Location of Parks	12
Priorities & Action Plan Schedule	12
Final Public Presentation of the Plan	13
ATTACHMENT A – PUBLIC SURVEY	14
ATTACHMENT B - PUBLIC MEETING ANNOUNCEMENT	15
ATTACHMENT C - COMMUNITY MAP & LOCATION OF PARKS	16
ATTACHMENT D – ADA/ABA/REHABILITATION ACT OF 1973 SECTION 504 ACCESSIBILITY COMPLIANCE FORM	17
ATTACHMENT E – PROOF OF PUBLICATION FOR FINAL PRESENTATION OF THE PLAN	19
ATTACHMENT F – PARK board RESOLUTION	20

PLAN AUTHOR

Erin Thomas
10459 Stoops Rd
Dillsboro, IN 47018
(812) 584-5292

PARK BOARD STATUTORY COMPLIANCE & BOARD CONTACT INFORMATION

Dillsboro's Park & Recreation Board, hereinafter referred to as the "Park Board", complies with Indiana State Statutes (I.C. 36-10-3 and I.C. 36-10-4) and has the following basic requirements:

- Staggered terms of service, where member terms all expire on different years
- No member of the local government fiscal body may serve on the Board
- No more than two members of any political party may serve on the board (unless waived by ordinance of the Town)

Park Board President: Tom Wafford

Term Expiration: January 2026

Address: 9790 Front Street, Dillsboro, IN 47018

Phone Number: (513) 607-8674

Email (if available): tomwafford@gmail.com

Park Board Vice-President: Thom Maltbie

Term Expiration: January 2025

Address: 12839 Trey Lane, Dillsboro, IN 47018

Phone Number: (812) 907-0504

Email (if available): tmaltbie@seidata.com

Park Board Secretary: Kyle Miller

Term Expiration: January 2027

Address: 12082 Schipper Court, Aurora, IN 47001

Phone Number: 812-655-3510

Email (if available): kyle.miller@sdsc.k12.in.us

Park Board Treasurer: Greg Hughes

Term Expiration: January 2027

Address: 7264 State Rd 62, Dillsboro, IN 47018

Phone Number: 812-655-3872

Email (if available): hughesg88@yahoo.com

Park Board Member: Sherri Cutter
Term Expiration: January 2024
Address: 8937 State Rd 262, Dillsboro, IN 47018
Phone Number: 513-505-5039
Email (if available): scutter10@hotmail.com

List of Park Department Paid Staff

Job Title: N/A

Name:

Address:

Phone Number:

Email (if available):

DEFINITION OF PLANNING AREA

The planning area includes the Town of Dillsboro, Clay Township, and Caesar Creek Township, hereinafter referred to as the "Community".

NATURAL FEATURES & LANDSCAPE

Each of the parks serve not only the town of Dillsboro, but the rest of Clay Township and neighboring Caesar Creek Township as well.

The parks have most of the same natural features as the surrounding area, which is relatively flat with only some rolling areas on the northwest end around the current soccer fields within the Community Park. The soil is clay based and not the easiest to work with but no significant barriers to prohibit maintaining grass playing surfaces or shrubs, trees, bushes, or grass in the recreational areas. The clay soil does not drain particularly well. Much work has been done on the "dirt" areas of the ball fields so that they drain well and are almost always playable. The grass area drainage can be improved.

Maple, Oak, and Cedar trees are most predominant within the park and surrounding area. There was once a good concentration of ash as well but those have been removed with the Emerald Ash Borer threats of a few years ago. Many trees have been taken down and the shade is not as plentiful as it once was but there are still trees providing shade for spectators on 2 of the 4 baseball/softball fields with some smaller trees planted for another field. Once plans are set for the upgrades on field #4, there will be trees planted around that field as well. One of the compliments Dillsboro Summer Ball gets every summer is that there is plenty of shade and comfort for spectators compared to many of the fields for local competitors.

There are two areas of the Community Park that can still be developed, and trees and landscaping can come into play on both. Depending on how they are used, drainage can be a factor and a possible expense. Different ideas have been thrown around toward how to use the grass area down by Field #4 and still allow drainage and runoff from that field in particular. The other parks are undeveloped, with potential for trees and other landscaping.

We have sought the advice of 2 local resources and their advice and connections could be a great help moving forward with any plans. Jeff Hermesh is our Purdue Extension agent for Dearborn County. Doug Berger is a retired park superintendent in Butler County, Ohio. He and Jeff both walked the grounds with us and provided some good input toward what may work in improving and utilizing the park. Both have volunteered their input and resources moving forward.

MAN-MADE, HISTORICAL, & CULTURAL

A local 1855 newspaper states, "Dillsborough is noted for roads – there being no less than 7 or 8 public roads crossing or terminating at this place." These same roads still connect Dillsboro to the surrounding farming areas, towns, and cities. One, a major east-west road, became U.S. Hwy 50. In 1855, the Baltimore and Ohio rail lines ran close to town and Dillsboro became known as the 2nd best business on the railroad, running between Cincinnati and St. Louis. Over time, the trains no longer stopped, and U.S. 50 became a 4-lane highway which bypassed our town.

One of our parks, Heritage Pointe, is centrally located in town where many of these roads crossed; thus, its name. This pocket park is where the Farmer's Market, Veteran's Day observances, town sponsored events and nearby Dillsboro Arts outdoor events take place.

The Dillsboro Oil and Gas Company, in 1900, found neither oil nor gas but did uncover an inexhaustible stratum of mineral water which showed qualities of medicinal value. The Dillsboro Sanitarium Company was incorporated in 1922. People visited to take advantage of the "healing waters" until the 1950's. Today, this area is a nursing home complex, but along one side, a small historical park is located - Sanitarium Well #2, which was a source of White Crane mineral water used at the historic Dillsboro Sanitarium health Resort. This Bicentennial Legacy Project area was gifted to the town by St. Elizabeth Medical Center in 2016. A small shelter house covers the original pump and two picnic tables.

Streets, sidewalks, and curbs through most of the downtown are in good condition, but improvements to all three need to be made in other sections of the town. Dillsboro recently took advantage of a \$20,000 planning grant for Community-wide Bicycle and Pedestrian Improvements, which was completed in March 2023. This plan was supported by funds made available from the Centers for Disease Control and Prevention (CDC), Center for State, Tribal, Local and Territorial Support, under NH75OT000073-01-00, administered by the Indiana Department of Health, Division of Nutrition and Physical Activity. The contents of this plan are those of the authors and do not necessarily represent the official position of or endorsement by the CDC. This plan was accepted as part of the Town Comprehensive Plan and will be the guide towards future improvements in connecting our existing trails and providing safe passage from all sections of town to our schools, preschools, business area, churches, and parks.

In 2016, the Dillsboro Heritage Festival was started. Every year, a different historical theme is displayed. This event has evolved to now include a historical scavenger hunt, pioneer games and activities for the youth, a car show, a baseball scrimmage, homemade ice cream, outdoor concert, and a Veterans' Walk which displays information about the veterans from our area. These events are held at the Civic Center, the Community Park, Heritage Pointe, and at the park that is known as the "green space".

Presently, there are no nighttime recreation options offered at three of our parks since there is no outdoor lighting; they are open from dawn to dusk. The “green space” does have several strands of overhead lights utilized whenever there is a concert or when the Veteran’s walk is on display.

If an organized event is happening in Dillsboro, it usually takes place in one of our parks or spread out to encompass several park sites. The Community Park and Heritage Pointe can be rented by individuals or organizations for special events.

The following is a condition assessment of the amenities at each park:

Park	Amenity	Condition Assessment	Comment
Well #2	Small Shelter House	Excellent	
Heritage Point	Vintage Clock	Good	
Heritage Point	Benches	Good	
North Street	N/A		This is a major opportunity for growth.
Dillsboro Community Park	4x Baseball Diamonds	Good	Needs safety netting to prevent foul balls from injuring bystanders.
Dillsboro Community Park	Fencing around Baseball Diamonds	Good	
Dillsboro Community Park	5x Soccer Fields	Fair/Good	The Kickers field needs to be leveled. The fields are not lit and cannot be used at night.
Dillsboro Community Park	Playground (Baseball Side)	Fair	Outdated
Dillsboro Community Park	Playground (Soccer Side)	Good	New mulch is being added in 2024
Dillsboro Community Park	Restrooms (Baseball Side)	Good	In good condition but can’t afford to keep them open or heat them outside of summer. An upgrade is needed to allow for year-round usage. In addition, the walkway to the restrooms is gravel, which is an accessibility issue.
Dillsboro Community Park	Restrooms (Soccer Side)	Good	In good condition but can’t afford to keep them open or heat them outside of summer. An upgrade is needed to allow for year-round usage.
Dillsboro Community Park	Pavilion (Baseball Side)	Poor	It was built in the 80s. In the immediate future, renovations will be made to the concession area. Ideally, the structure would be replaced with one that is larger and more efficient.
Dillsboro Community Park	Pavilion (Soccer Side)	Excellent	Utilized more frequently than the baseball side.
Dillsboro Community Park	Walking Trail	Excellent	This is used year-round, despite the lack of restrooms.

Dillsboro Community Park	Parking Lot (Baseball Side)	Good	The number of spaces is not sufficient to meet needs. Lighting is needed to ensure safety.
Dillsboro Community Park	Parking Lot (Soccer Side)	Good	The number of spaces is not sufficient to meet needs. Lighting is needed to ensure safety.
Dillsboro Community Park	Shelter House (Baseball Side)	Fair	There is no electricity to the shelter house. There is a need for electricity in this area.
Dillsboro Community Park	Swings (Baseball Side)	Poor	A need for additional mulch has been identified and will need to be added in the future.
Dillsboro Community Park	Swings (Soccer Side)	Good	The accessible swings need additional supports.
Dillsboro Community Park	Gaga Ball Arena	Excellent	The arena is in good condition, but the availability of the ball is a concern. Could be checked out through the concession stand.
Dillsboro Community Park	Bleachers	Poor	Some are too high, with no handrails or enclosure
Dillsboro Community Park	Lighting	Poor	Few lights remaining, no ballasts. Need more efficient LED lighting. Non-existent on the soccer side.
Dillsboro Community Park	Flagpole (Soccer Side)	Good	
Dillsboro Community Park	Flagpole (Baseball Side)	Poor	The pole is broken and need to be replaces, as well as lighting added.
Dillsboro Community Park	Security Cameras	Good	Additional cameras are needed to ensure safety. At this time, Wifi is needed so cameras can be monitored by the police departments.
Dillsboro Community Park	Batting Cages	Fair	The netting is poor. No lighting. A roof with gutters is needed. More batting cages could be a revenue stream.

SOCIAL & ECONOMIC FACTORS

The social and economic data in this section was derived from the following sources: U.S. Census Bureau (2020), Southeastern Indiana Regional Planning Commission, One Dearborn, Inc., Indiana Department of Workforce Development.

	Dillsboro	Clay Township	Caesar Creek Township
Total Population	1,360	2,844	257
Median Age	41	47	70
% At or Below Poverty	26%	17.5%	9.7%

% Under the Age of 5	6.5%	4.6%	0%
% Over the Age of 65	24.5%	19.4%	50.7%
% with a Disability	20.1%	18.4%	33.8%
Race/Ethnicity			
% White	95.3%	95%	97.7%
% Black or African American	.15%	.11%	0%
% American Indian/Alaska Native	.22%	.14%	0%
% Asian	.37%	.32%	.39%
% Native Hawaiian/Other Pacific Islander	0%	0%	0%
% Other	.3%	.53%	0%
% Two or More Races	3.3%	3.05%	.39%
% Hispanic or Latino Ethnicity	1.258%	1.44%	1.56%
Median Household Income	\$36,422	\$56,314	\$x
Unemployment Rate (Dearborn County)	2.5%		

From the 2010 to 2020 census, the total population decreased by 1.5%. While Dillsboro and Caesar Creek Township's populations increased by 33 and 19, respectively, Clay Township's population decreased by 122. It is important for Dillsboro to invest in amenities that will positively impact the quality of life of its residents and attract new residents, businesses, and revenue streams. However, the ability to raise local match, manage/afford reimbursement-based grants and the ability to adequately sustain any new amenities must be considered ahead of any new endeavor and revenue-generating projects must be prioritized. Dillsboro is fortunate to have various foundations and other sources of local match that may be willing to support various efforts.

Largest Employers

The largest employers, per www.hoosierdata.com are as follows:

	Approximate Employees
Dillsboro	
1. Waters of Dillsboro-Ross Manor	150
2. LifeTime Resources, Inc.	90
3. Dillsboro Elementary School	45
4. Multiple Machining, Inc.	23
Clay Township	
1. SEI Communications	50
2. Lischke Motors	20
3. Mobil	10
4. Double D Construction LLC	5
Caesar Creek Township	
1. Poole Engineering LLC	10
2. Beverly Industrial Services	10
3. Indiana Precision Tooling Inc.	5
4. Goodwin Landscaping	4

PARK DEPARTMENT INFORMATION & FACILITY INVENTORY

The following parks are owned by the Town of Dillsboro and/or operated by the Board:

Name of Park	Well #2	Heritage Pointe	North Street Park ("The Green Space")	Dillsboro Community Park
Address (or Nearest Intersection)	12827 Lenover Street	Bank Street & North Street	North Street & Front Street	9495 Arlington Road
Approximate Acres	.09	0.25	1	12
Major Facilities/ Amenities	A small shelter houses the historic Sanitarium Well #2.	Located in the town center, at the intersection of the main roads, it houses a vintage clock and benches, surrounded by landscaping.	This space is currently just a grassy area, near the center of town, where "pop-up" events (craft shows, concerts, memorials, etc.) are held.	4x Baseball Diamonds (Accommodating Pre-School through High School Players), 5x Soccer Fields (Accommodating Pre-School through High School Players), 2x Playgrounds, 2x Sets of Public Restrooms, 2x Storage/Concession Pavilions, a shelter, and a .84 mile Walking Trail
2023 Budget	\$0	\$15,000	\$15,000	\$23,000
2022 Budget	\$0	\$15,000	\$15,000	\$23,000
2021 Budget	\$0	\$15,000	\$15,000	\$23,000

The Town of Dillsboro has supported these parks through tax-based appropriations and very limited revenue from shelter rentals. However, their upkeep has become a strain on the Town’s budget and grants and/or additional sources of revenue would be needed for additional improvements.

The only other public recreational areas in the Community are the gym and playground at Dillsboro Elementary School.

ACCESSIBILITY & UNIVERSAL DESIGN

At the Dillsboro Community Park, all sidewalks leading to the park have ADA ramps. The southern/baseball side provides accessibility to the parking area, concession area, walking trail, and three of the four baseball diamonds; all interconnected. It lacks accessibility to the playground, swings, and gaga ball arena. The number of handicapped parking spaces meets the requirement and the spaces are striped and have signage. The northern/soccer side of the park provides accessibility to the parking area, concession area, restrooms, walking trail, and the playground, as well as visibility to most of the playing fields; all interconnected. While the playground was designed to be accessible, there is need to replace the current mulch surfacing. The number of handicapped parking spaces meets the requirement, and the spaces are striped and have signage. The northern and southern sides are also connected by an accessible path. The park is open to the public from dawn until

dusk and is also utilized by several community organizations and programs (SAY Soccer, Dillsboro Summer Ball, Munch-A-Lunch, etc.) as well as informal groups who gather to play Ultimate Frisbee, for example.

At Heritage Pointe, there is no parking within the park itself. The parking lot between Heritage Pointe and Friendship Gallery has parking with ADA accessibility to Heritage Pointe. There are a few street parking areas, which are adjacent to the sidewalks surrounding the Pointe's paved surface, which are not marked or striped for the handicapped. There is a parking lot across the street that does have handicapped parking spots available; however, it is not specifically part of the park. There are no amenities at this park.

The North Street Park and Well #2 do not have any amenities at this time, nor do they have any internal sidewalks or parking. There is parking adjacent to both areas, but not within the parks themselves. The North Street Park is a grassy area, known as "The Green Space", often utilized for craft fairs, concerts, holiday decorations, and the Veteran's Walk.

Presently, the public is not being notified about ADA's nondiscriminatory requirements; nor are there any accessibility facilities, programs, or services. Notices and flyers could be displayed on the south side in the enclosed bulletin board mounted in the concession area. An additional enclosed bulletin board would be needed for the other end of the park; it could be mounted near the north side concession area.

Questions, comments, and/or issues related to accessibility in the park system, programs, or activities may be directed to:

Name/Job Title: Susan Grecco, Town Manager

Address: 13030 Executive Drive, Dillsboro, IN 47018

Phone Number: 812-432-9002

A hard copy, with original signatures, of the ADA/ABA/Rehabilitation Act of 1973 Section 504 Accessibility Compliance Form will be sent to the DNR-Outdoor Recreation Local Master Planner, along with the finalized plan. A copy has been provided in ATTACHMENT D.

PUBLIC PARTICIPATION

To ensure input was gathered from as many Community members as possible, one random public input method (a survey) and one non-random method (a public meeting) were conducted.

Survey Information

Survey Type: Electronic (via QuestionPro) and Hard Copy (See ATTACHMENT A)

Survey Date Range: April to October, 2022

Advertising Methods: Town Newsletter, Facebook Posts, School News Bulletin, Church Bulletins, Mass Emails, and Flyers (with QR codes) posted at local businesses, apartment complexes (including low income and senior housing), and the Dillsboro Community Park. Hard copies were distributed at Baseball Opening Day and other community events.

Responses: 135 surveys were completed and an additional 38 were started/incomplete. Demographic data showed that survey respondents included males & females, an age range from <21 to 91+, multiple ethnicities, and households of 1-6+. 87% of respondents were residents of Dillsboro, Clay Township or Caesar Creek Township. 89% had visited at least one of the parks in the last year. 10% had experienced a barrier to accessing the parks, such as lack of sidewalks, ramps, etc.

Comments & Issues Discussed: Suggestions ranged from new or upgraded facilities and amenities to maintenance and landscaping to activities.

Public Meeting Information

Meeting Date & Time: Tuesday, November 15th, 2022 @ 7pm

Meeting Location: Dillsboro Town Hall – 13030 Executive Drive, Dillsboro, IN 47018

Advertising Methods: Town Newsletter, Facebook Posts, School News Bulletin, Mass Emails, and Flyers posted at local businesses, apartment complexes (including low income and senior housing), and the Dillsboro Community Park. (See ATTACHMENT B)

Attendance: Fifteen members of the public attended the meeting.

Comments & Issues Discussed: Attendees were shown a PowerPoint presentation, detailing the purpose and results of the Dillsboro Community Park Survey. They were encouraged to share any additional ideas for our parks, which resulted in two additional suggestions; a Ninja Warrior course and historical information being placed along walking trails.

The suggestions from the Dillsboro Community Park Survey and the two new suggestions were displayed on easels around the room. Attendees were each given six stickers and asked to vote for their top five suggestions and to place a star next to their top “wish list” suggestion.

This meeting also served as an opportunity to ask community members if they would be interested in serving on Dillsboro’s Park & Recreation Board.

NEEDS ANALYSIS

Total Acres of Local Parks & Recreational Land: 13.34

Total Population: 4,461

Top 5 Most Common Needs or Desires Expressed by the Public:

1. Splash Pad/Pool
2. Movies in the Park
3. Dog Park
4. Basketball Court
5. Improve/Upgrade Playground Equipment/Amenities

Top 5 Most Common Needs or Desires Expressed by the Park Board/Advisory Committee:

Members felt it was important to prioritize safety and accessibility as well as anything that could potentially lead to greater use of the parks and revenue generation. They also recognized that there are a couple of relatively inexpensive “low hanging fruit” items that are important to the public and should be prioritized.

1. Playground/Amenities – Discussed ideas such as equipment, inclusive of children and adults of all ages and abilities, frisbee golf, exercise stations, etc. Agreed with the public’s expressed need for a dog park, as community members currently close the gates to the baseball fields and let their dogs run, dig, and relieve themselves on the field, causing damage to the fields as well as sanitation and health concerns.

2. Safety/Accessibility – Additional mulch, relocation or removal of the swings at the Community Park, and a paved pathway to the bathrooms on the baseball side of the park are needed to ensure safety/ADA compliance. Moving the basketball goal from its current location near the parking lot would decrease safety concerns; could potentially put in a court by the soccer fields that would also double as a pickleball court (as its increasing in popularity). Other concerns/ideas included nets to avoid injury from foul balls (which are frequently landing in the spectator area), picnic tables with wheelchair accessibility, an area for wheelchair users to more easily view games, pathways and ramps, a loud speaker system, lightning detection system, signage, etc.
3. Increased Parking at the Community Park – This would allow for larger tournaments; a potential increased revenue stream.
4. A Stage at “The Green Space” – A permanent stage, ideally including bathrooms, may increase interest and feasibility of regular concerts, events, etc. and could bring in additional revenue.
5. Bike/Walking Pathways – Would like to see improvements to existing and increased pathways that extend beyond the Community Park to other parks/areas of the community.

Dream Project: As there was such high public interest in a pool or splashpad, pros/cons of each were weighed and members felt that a small splash pad would be a more realistic dream project, as it would be less costly and easier to maintain. Estimated costs of a splash pad is \$100,000.

COMMUNITY MAP & LOCATION OF PARKS

Below is a list of the Community’s four parks:

1. Well #2 - 12827 Lenover Street
2. Heritage Point - Bank Street & North Street
3. North Street Park (“The Green Space”) - North Street & Front Street
4. Dillsboro Community Park - 9495 Arlington Road

Please refer to the map in ATTACHMENT C.

PRIORITIES & ACTION PLAN SCHEDULE

1. Movies in the Park
2. Dog Park
3. Mulch in existing playgrounds
4. Netting between baseball fields
5. Bike/Walking Pathways
6. Increased Parking at the Community Park
7. Basketball/Pickleball Court
8. Stage/Restrooms at North Street Park
9. Inclusive Playground Equipment
10. Improved Amenities for Older Adults

Priority #	Year	Site	Action Taken	Cost Estimate	Potential Source of Funds
1. Movies in the Park	2023	N. Street Park/ Community Park	Estimated Costs	\$5,000	Fundraising, Equipment Sharing with Local Non-profit

2. Dog Park	2023	Community Park	Estimated Costs	\$25,780	Fundraising, Grants
3. Mulch	2023	Community Park	Estimated Costs	\$10,000	REMC Grant, Budget
4. Netting	2024	Community Park	Estimated Costs	\$50,000	REDS Grant
5. Bike/Walking Pathways	2026	All Parks	Estimated Costs	\$200,000	CCMG Grant
6. Parking	2026	Community Park	Estimated Costs	\$150,000	Fundraising, Grants
7. Basketball/ Pickleball Court	2026	Community Park	Estimated Costs	\$50,000	Fundraising, Grants
8. Stage/ Restrooms	2027	North Street Park	Estimated Costs	\$115,000	Fundraising, Grants, Civic Club Collaboration
9. Inclusive Playground	2028	Community Park	Estimated Costs	\$100,000	Fundraising, Grants
10. Improved Amenities for Older Adults	2028	Community Park	Estimated Costs	\$100,000	Fundraising, Grants

FINAL PUBLIC PRESENTATION OF THE PLAN

Meeting Date & Time: Monday, December 11, 2023 @ 6pm

Meeting Location: Dillsboro Town Hall – 13030 Executive Drive, Dillsboro, IN 47018

Advertising Methods: Facebook posts, mass emails and texts, and Register Publications.

(See ATTACHMENT E)

Attendance: X members of the public attended the meeting.

Comments & Issues Discussed: Attendees were reminded of the purpose of the plan and the steps taken to gather public input, and then shown a presentation of the final plan, as well as being offered a paper copy. They were encouraged to provide additional feedback, which resulted in.....



Dillsboro Parks Community Survey

Dillsboro's Park Advisory Board would like input from residents of all ages and abilities to help in the creation of an inclusive strategic plan that adequately represents the interests of its community members. The following four parks will be addressed in the plan:

- (1) Heritage Point – Bank Street & North Street
- (2) Dillsboro Community Park – 9495 Arlington Road
- (3) Green Space – North Street & Front Street
- (4) Well #2 – 12827 Lenover Street

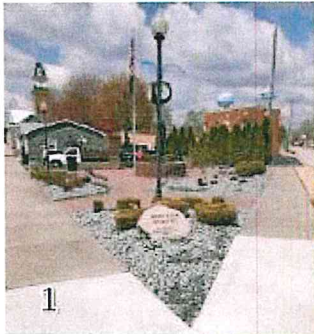

- 1) Are you a resident of the Dillsboro Community (Clay or Caesar Creek Township)? YES NO
- 2) What year were you born? _____
- 3) What is your gender? MALE FEMALE PREFER NOT TO SAY
- 4) What is your ethnicity? CAUCASIAN AFRICAN-AMERICAN LATINO/HISPANIC OTHER: _____
- 5) How many people live in your household (including you)? _____
- 6) How many children ages 5-18 live with you? _____ How many children under 5 live with you? _____
- 7) Have you visited any of the Dillsboro parks within the last year? YES NO
- 8) Are there barriers to your ability access the parks (e.g., lack of sidewalks, lack of ramps)? YES NO
If YES, please provide details:

- 9) Are there improvements or amenities that could be added in order to make the park(s) more appealing to you and/or your family (e.g., dog park, movie in the park, pickleball, tennis, landscaping)? YES NO
If YES, please list any suggestions you may have:

Please return completed surveys to Dillsboro Town Hall (13030 Executive Drive, Dillsboro, IN 47018). Drop Box available.
Alternatively, you can scan the QR code above or visit <https://www.questionpro.com/t/AVUF9ZsQBR>



Dillsboro Parks & Recreation Master Plan Public Meeting

Join us for a public meeting on **Tuesday, November 15th @ 7pm** at Dillsboro Town Hall and, after listening to recent survey results, vote on the projects that you would like to see included in Dillsboro's 5-Year Parks and Recreation Master Plan.

We encourage participation from all ages, abilities, occupations, races, and ethnicities to ensure we consider the diverse needs of our community.

The completion of a 5-Year Parks and Recreation Plan allows us the opportunity to apply for grants that may help bring our plan to life. The plan addresses the following four parks:

- (1) Heritage Point – Bank Street & North Street
- (2) Dillsboro Community Park – 9495 Arlington Road
- (3) Green Space – North Street & Front Street
- (4) Well #2 – 12827 Lenover Street



**Make sure your voice is heard and
enter to win a \$20 Janet's Diner Gift Card!**

Dillsboro Town Hall – Tuesday, November 15th, 2022 @ 7pm

ATTACHMENT C - COMMUNITY MAP & LOCATION OF PARKS

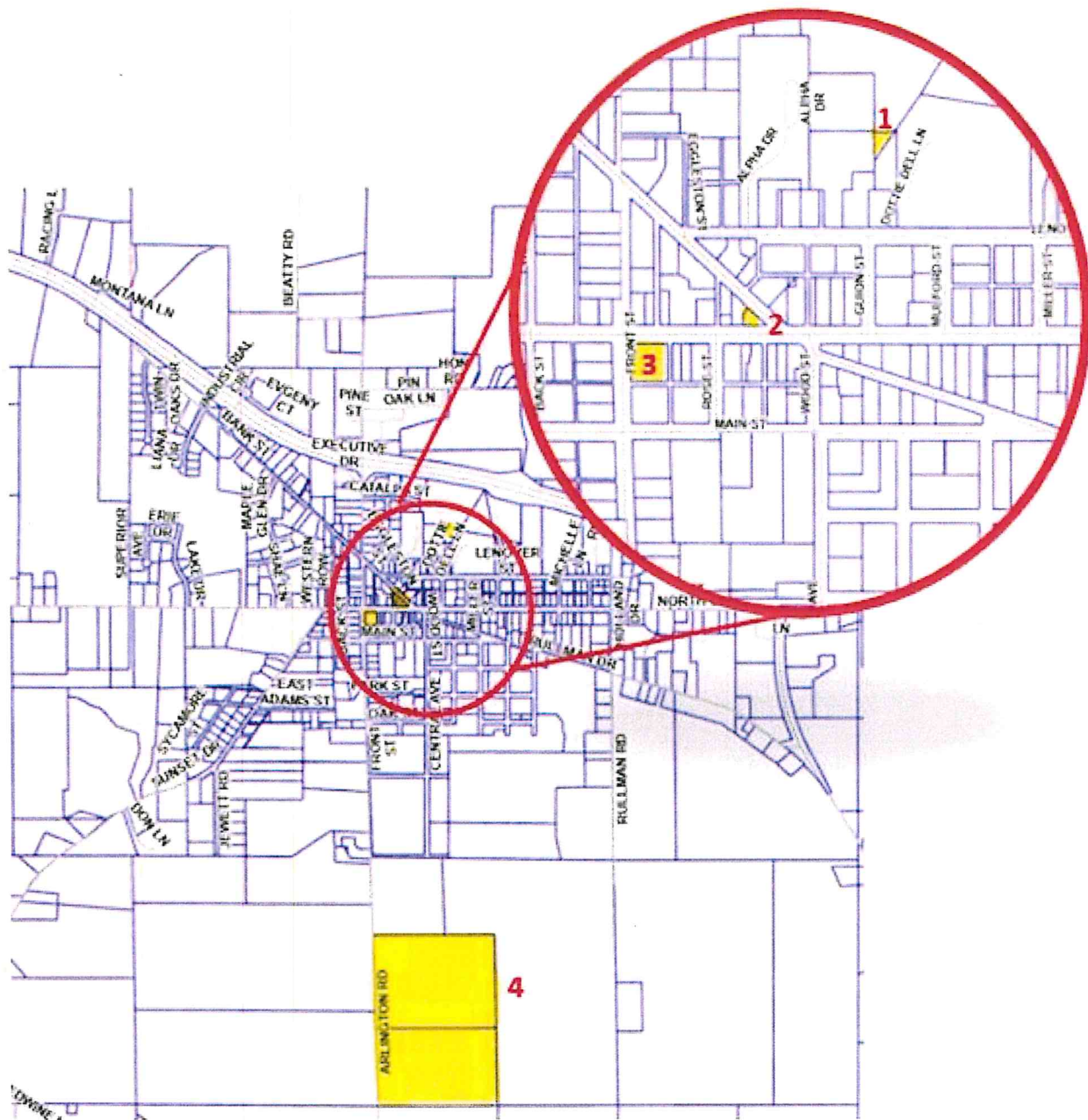

1. Well #2 - 12827 Lenover Street
2. Heritage Point - Bank Street & North Street
3. North Street Park ("The Green Space") - North Street & Front Street
4. Dillsboro Community Park - 9495 Arlington Road

**ASSURANCE OF ACCESSIBILITY COMPLIANCE WITH:
ARCHITECTURAL BARRIERS ACT of 1968 (As Amended);
SECTION 504 OF THE REHABILITATION ACT OF 1973 (As Amended);
AND TITLE II OF THE AMERICANS WITH DISABILITIES ACT OF 1990
(As Amended)**

The *Dillsboro Park Board* has read the guidelines for compliance with the Architectural Barriers Act of 1968 (As Amended); Section 504 of the Rehabilitation Act of 1973 (As Amended); and Title II of the Americans with Disabilities Act of 1990 (As Amended) and will comply with the applicable requirements of these Acts.

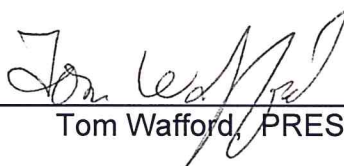

Tom Wafford, PRESIDENT



Kyle Miller, Secretary

DATE December 11, 2023

ATTACHMENT E – PROOF OF PUBLICATION FOR FINAL PRESENTATION OF THE PLAN

AFFIDAVIT OF PUBLICATION

County of Dearborn, State of Indiana

<i>The Register</i>	
221 Walnut Street Lawrenceburg, IN 47025	1701520-Town of Dillsboro Notice of Public Hearing Regarding the 5-Year Park Master Plan

I, the publisher/agent of the Register of Dearborn County, in the State of Indiana, States that this newspaper is a qualified newspaper, published and of general circulation in said county, was published in regular edition of said paper, and that the notice of which the annexed is a copy was published on the following dates:

PUBLICATION DATES
November 30, 2023

Sherry Groves

Sherry Groves

Signed and sworn to before me on this

4 / 12 2023
Day Month Year

Staci Woods

Signature above, NOTARY NAME, Notary Public
My commission expires.
Commission#

September 7, 2025

Seal

Publication Fee \$ 25.01

Calculation Measurement

Words	Tab lines	Columns	Insertions
-------	-----------	---------	------------

CherryRoad Media

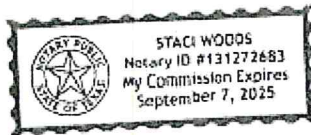

**Public Notice
Dillsboro Town Council and
Dillsboro Parks and
Recreation Board
5-Year Master Park Plan**

The Dillsboro Town Council and the Dillsboro Parks and Recreation Board invite the Public to attend a presentation and review of the Dillsboro Five-Year Master Park Plan. A 5-Year Park Master Plan is a requirement by the Indiana Department of Natural Resources (IDNR) to be eligible for state and federal grant programs such as the Land and Water Conservation Fund (LWCF) and the Recreational Trails Program (RTP) grants - Both funding opportunities that are provided through the DNR Division of Outdoor Recreation. The Hearing will be held at 6:00 PM on Monday, December 11, 2023 at the Dillsboro Town Hall, 13030 Executive Drive. The Town Council will meet immediately following.

Resolution Accepting the
Dillsboro Park and Recreation Master Plan

WHEREAS, the Dillsboro Park and Recreation Board is aware of the parks and recreation needs of the residents of Dillsboro, Indiana, and

WHEREAS, the Dillsboro Park and Recreation Board realizes the importance of sound planning in order to meet the needs of its citizens,

NOW, THEREFORE, BE IT RESOLVED THAT THE DILLSBORO PARK AND RECREATION BOARD, by unanimous declaration, does adopt the *Dillsboro Park and Recreation Master Plan* as its official plan for the next five years, for the growth and development of parks and recreational opportunities in Dillsboro, Indiana.

Passed and signed this 11th day of December, 2023.

ATTEST:



Thomas Wafford, Board President

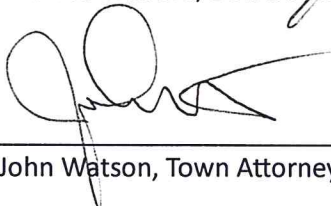

John Watson, Town Attorney

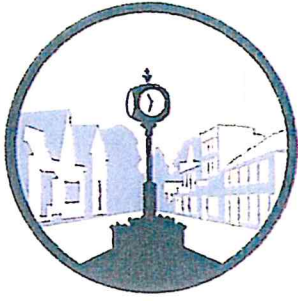

RESOLUTION 2023-12-1

A RESOLUTION APPROVING THE ADOPTION OF THE DILLSBORO PARKS AND RECREATION MASTER PLAN

WHEREAS, the Town Council of Dillsboro, Indiana is aware that the Comprehensive Plan for the Town does not contain a Parks and Recreation Master Plan, and

WHEREAS, the Town Council of Dillsboro, Indiana has created a Park Board, made use of a steering committee and has offered several opportunities for input and has considered that input in developing the new Parks and Recreation Master Plan for Dillsboro, Indiana, and

WHEREAS, the Town Council of Dillsboro, Indiana is hopeful that this new plan will supplement The Comprehensive Plan in assisting public and private entities in planning for future development and redevelopment of the incorporated Town of Dillsboro, and

WHEREAS, the Park Board of Dillsboro, Indiana, after notice to the public, held a public hearing on the draft Parks and Recreation Master Plan for the Town of Dillsboro, Indiana. After hearing public input, the Dillsboro Park Board voted to recommend that the Town Council of Dillsboro, Indiana adopt this Park and Recreation Master Plan as an element of the Town's Comprehensive Plan.

WHEREAS, this finished project of the Park Board of Dillsboro, Indiana has be presented to the Town Council of Dillsboro, Indiana, in a document entitled "Dillsboro Parks and Recreation Master Plan, December 2023."

BE IT THEREFORE RESOLVED, by the Town Council of Dillsboro, Indiana, that the Council accepts and approves the "Dillsboro Parks and Recreation Master Plan", as a new element of the Town's Comprehensive Plan, and said plan element is now in full force and effect,

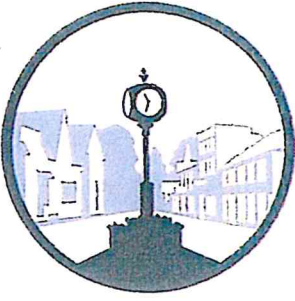

ADOPTED THIS 1TH DAY OF December 2023,

Common Council of the Town of Dillsboro, Indiana

ATTEST:

Doug Baker

Doug Baker

Becky Fryman

Becky Fryman

Tim Benning

Tim Benning

Charlie Caldwell

Charlie Caldwell

Jerri Jackson

Rita Stevens

Rita Stevens, Clerk-Treasurer

Parks Recreation Plan Meeting
12/11/23

Name	Address	Phone Number	Email
Cherie Rump	10030 Tampa Rd Kellerville	812-432-5648	rumpc@hotmail.com
Jovon Barber	12847 Fenwick St Dorchester	812-552-9787	
STEPHEN BARBER	12847 Fenwick Street Dorchester	812-532-9324	
Jenny Caldwell	9545 SR 262 Dr West Jm 4704	912-621-3455	
Carne Miller	13237 Schmeltz Rd Moore Hill IN 47033	812.290.1452	

Parks Recreation Plan Meeting
12/11/23

Name	Address	Phone Number	Email
Sue Stevens	12359 Rullman		
Annie Caldwell	13069 Bank St.		
Betsy Juhn	9789 Central Ave		
Amy Baker	9792 Central Ave		
Tommy	13111 North St		
Dan West	9594 N. Hwy Grandale	812-579-4150	
Tim Heitmyer	9740 Forest St.	812-584-3868	
Susan Shero	13088 Bank St.	812-571-3775	
Josh Cady	15917 Possum Ridge Rd		jcadyc@turnofdillstore.com
Tom WATFIELD	9990 FLOUT ST	513-607-8674	
Sherril Cutten	8937 St. Rd. 202		
Greg Hughes	726 W. S. Rd 602	812-655-3822	hughes88@yahoo.com
Thom Mathie	12839 Trey Lane Dallas	812-907-0504	fmathie@cedarstg.com
Kyle Miller Becky Chapman	12082 Scripps Ct Aurora 8905 Durand Rd Dillstore	812-655-3510 513-504-2917	kylemiller3@gmail.com

